

THE MOUNTAINEERS
SEATTLE PROGRAM CENTER MAP

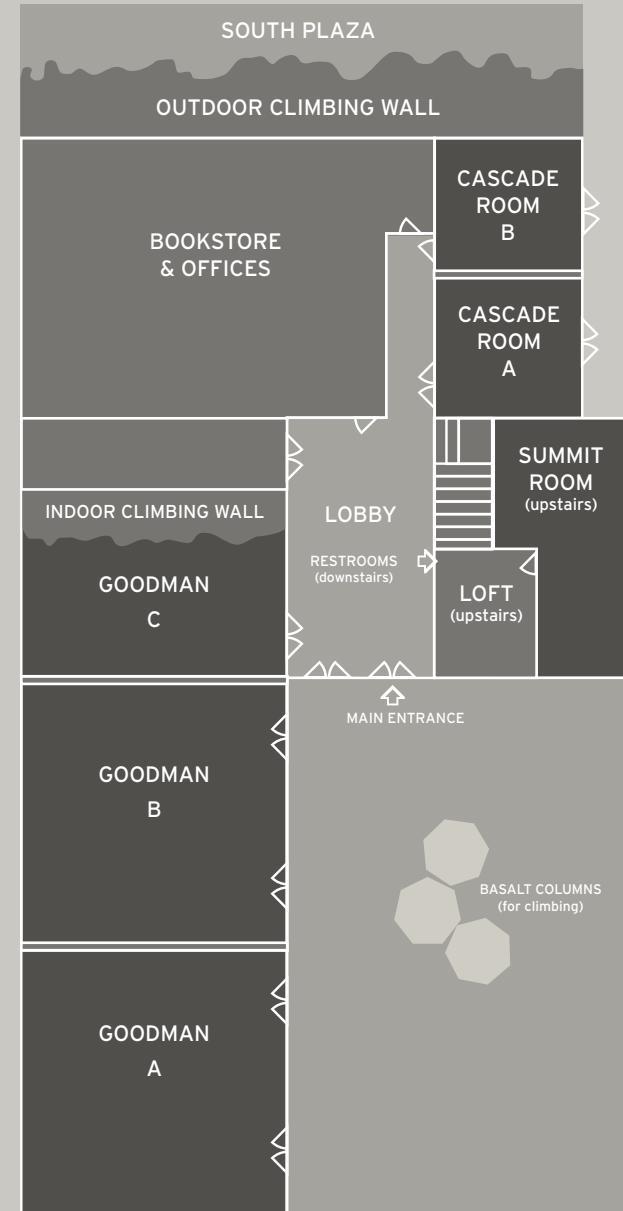

NORTH PLAZA

not to scale - for directional use only



The outdoor ambiance of the facility combined with quality amenities make The Mountaineers Program Center a unique location for your next workshop, fundraiser or social gathering.

We offer a variety of rooms that can accommodate 10-500 people - anything from a small meeting to a large film festival. Room rentals come with modern AV capabilities in addition to friendly and knowledgeable staff to help make your program a success. Parking is abundant and free.



The Mountaineers is a 501(c)(3) non-profit organization. Our mission is to enrich the community by helping people explore, conserve, learn about and enjoy the lands and waters of the Pacific Northwest and beyond.

7700 Sand Point Way NE
Seattle, Washington 98115
rentals@mountaineers.org
206-521-6005
mountaineers.org/SeattleProgramCenter

SEATTLE
PROGRAM CENTER
FACILITY RENTAL INFORMATION



GOODMAN AUDITORIUM

Our building has two main meeting rooms, the largest of which is our Goodman Auditorium. You can book the full auditorium for larger events, or rent smaller sections separated by air-walls. The Goodman C section contains our indoor climbing wall, which is often an inspirational curiosity for event attendees.

GOODMAN B & C

Size: 42'x66'
Weekday (M-F): \$840 for 4 hrs/\$125 each additional hour
Weekend (Sat-Sun): \$1,370 for 4 hrs/\$210 each additional hour
Seating Capacity: Theater: 220; Banquet: 150; Classroom: 115
AV: 1 screen on the east wall, with audio-visual setup available
Ideal for: workshops, conferences, presentations



Top, left to right: Cascade room, program center lobby, and program center entrance.



Top, left to right: Goodman A and B, looking north; Goodman C, looking south with climbing wall.

ENTIRE AUDITORIUM

Size: 42'x108'
Weekday (M-F): \$1,330 for 4 hrs/\$160 each additional hour
Weekend (Sat-Sun): \$2,120 for 4 hrs/\$235 each additional hour
Seating Capacity: Theater: 500; Banquet: 300; Classroom: 225
AV: 2 screens with audio-visual setup available
Ideal for: film festivals, conferences, presentations, auctions

GOODMAN A & B

Size: 42'x84'
Weekday (M-F): \$945 for 4 hrs/\$145 each additional hour
Weekend (Sat-Sun): \$1,500 for 4 hrs/\$235 each additional hour
Seating Capacity: Theater: 300; Banquet: 200; Classroom: 150
AV: 2 screens with audio-visual setup available
Ideal for: workshops, conferences, presentations

GOODMAN A OR B (ROOMS ARE THE SAME SIZE)

Size: 42'x42'
Weekday (M-F): \$480 for 4 hrs/\$110 each additional hour
Weekend (Sat-Sun): \$750 for 4 hrs/\$155 each additional hour
Seating Capacity: Theater: 160; Banquet: 100; Classroom: 75; Conference: 50
AV: each section has a screen and audio-visual setup available
Ideal for: workshops, small gatherings, meetings

GOODMAN C

Size: 24'x35'
Weekday (M-F): \$385 for 4 hrs/\$65 each additional hour
Weekend (Sat-Sun): \$620 for 4 hrs/\$70 each additional hour
Seating Capacity: Theater: 60; Banquet: 50; Classroom: 40; Conference: 36
AV: Pop-up screen and audio-visual setup is available
Ideal for: workshops or meetings

CASCADE AUDITORIUM

The Cascade is the smaller of our two main meeting rooms. You can book the full room for medium-sized events, or rent a smaller section separated by an air-wall.

CASCADE - ENTIRE AUDITORIUM

Size: 23'x42'
Weekday (M-F): \$410 for 4 hrs/\$70 each additional hour
Weekend (Sat-Sun): \$660 for 4 hrs/\$75 each additional hour
Seating Capacity: Theater: 70; Banquet: 50; Classroom: 36; Conference: 36
AV: 1 screen and audio-visual setup available
Ideal for: workshops, presentations, meetings

CASCADE A OR B

Size: 21'x23'
Weekday (M-F): \$220 for 4 hrs/\$65 each additional hour
Weekend (Sat-Sun): \$330 for 4 hrs/\$65 each additional hour
Seating Capacity: Theater: 25; Banquet: 20; Classroom: 12; Conference: 18
AV: 1 screen and audio-visual setup available. Cascade A comes with a built-in projection screen, and a pop-up screen is available to use for Cascade B.
Ideal for: small meetings or workshops

ADDITIONAL INFORMATION

The minimum rental time is four hours. Your rental price will be prorated by the hour if you need the space longer. We do not have a kitchen on site, but a staging area will be provided. Please contact us about our list of preferred caterers. Call or email for more details regarding our decoration policies. Our facility is not available for weddings.

To see space availability, visit mountaineers.org/SeattleProgramCenter/AllEvents

EQUIPMENT INFORMATION

Item	Qty.	Price
TABLES AND CHAIRS		
60" Round Tables	30	Included
6' White Plastic Tables	25	Included
6' Wood Table	25	Included
1.5' x 5' Wood Table	9	Included
30" Cocktail Table (with black linens)	16	\$15 each
Stackable chairs - Brown	75	Included
Stackable Chairs - Grey	447	Included
AV EQUIPMENT		
Podium (standing and tabletop)	3	Included
Portable Projector Screen	3	Included
LCD Projector	5	\$50
Microphone(s)	6	1 Included, \$25 each additional
Large Easel	4	Included
Flip Chart Easel (without paper)	5	Included
Paper Flip Charts	N/A	\$15 each
White Board (portable)	2	Included
16'x 8'x 16" stage (modular with 4'x 4' panels)	N/A	Inquire
Audio Hookup for Presentations	N/A	Included
Event Uplighting	4	\$35 each